



---

# Service Manual

## Freestanding Double Door ARC 4208 IX

---

<b>Model Version</b>		<b>Page</b>
	ARC 4208 IX	
	8501 420 11120	
	Technical data	2
	Spare part list	3
	Exploded view	4 - 5
	Circuit and Wiring diagram	6

**R o H S**

**Technical data**

**Dimensions**

Height	187.4	cm
Width	70.9	cm
Depth	72.8	cm

**Capacity**

<b>Total</b>		
gross	439	l
net	432	l
<b>Cooling</b>		
gross	329	l
net	325	l
<b>Freezing</b>		
gross	110	l
net	108	l

**Electrical connection**

Voltage	220 - 240 V
Frequency	50 Hz

**Rated Power**

120 W

**Rated Current**

1.3 A

**Power consumption**

in 24 hours 1.2 kWh

**Freezing capacity**

in 24 hours 7.5 kg

**Compressor (freezing)**

Type	EMX 70 CLC
Capacity (CECOMAF)	191 W

**Refrigerant (freezing)**

Type	R 600 a
Quantity	44 g

**Thermostat (Cooling)**

Thermo-Mechanic (Damper)

**Thermostat (Freezing)**

Electronic

**Thermostat switching value (cooling)**

MIN.		
Switch on temperature	+ 8.0	°C
Switch off temperature	+ 6.0	°C
MED.		
Switch on temperature	+ 6.0	°C
Switch off temperature	+ 4.0	°C
MAX.		
Switch on temperature	+ 3.0	°C
Switch off temperature	+ 1.0	°C

**Thermostat switching value (freezing)**

MIN.		
Switch on temperature	- 17.0	°C
Switch off temperature	- 23.0	°C
MED.		
Switch on temperature	- 20.0	°C
Switch off temperature	- 26.0	°C
MAX.		
Switch on temperature	- 23.0	°C
Switch off temperature	- 29.0	°C

## Spare part list

Model **ARC 4208 IX**  
Service No. **850142011120**  
Version **850142011120**

Pos. No.	12NC Code	Description	Pos. No.	12NC Code	Description
003 0	<b>4812 466 99005</b>	Crossbar compressor	255 2	<b>4812 450 88479</b>	Shelf freezer
011 0	<b>4812 462 18246</b>	Adjusting screw	256 0	<b>4812 123 38002</b>	Diaphragm
012 0	<b>4812 528 78071</b>	Roller	256 1	<b>4812 460 49848</b>	Support
012 1	<b>4812 535 48034</b>	Shaft roller	256 2	<b>4812 460 48886</b>	Cover
012 3	<b>4812 528 78072</b>	Roller	256 3	<b>4812 411 68012</b>	Slide
040 0	<b>4812 417 19285</b>	Hinge upper	256 4	<b>4812 411 68013</b>	Slide
040 1	<b>4812 462 79929</b>	Cover hinge	261 4	<b>4812 462 38211</b>	Rail + stopper right
040 2	<b>4812 417 19284</b>	Hinge	261 5	<b>4812 462 38212</b>	Rail + stopper left
040 3	<b>4812 462 79931</b>	Cover gray	261 6	<b>4812 462 38213</b>	Rail
040 4	<b>4812 462 79928</b>	Cover gray	320 1	<b>4812 464 69318</b>	Control panel
040 5	<b>4812 417 19277</b>	Hinge	320 2	<b>4812 464 69321</b>	Control panel reflector
040 6	<b>4812 417 19278</b>	Pin hinge lower	320 3	<b>4812 464 69319</b>	Control panel switch
040 7	<b>4812 446 88148</b>	Door revers. Kit left	402 0	<b>4812 360 39073</b>	Compressor EMX 70 CLC
040 8	<b>4812 417 19331</b>	Hinge left	402 1	<b>4812 418 18667</b>	Tray compressor
040 9	<b>4812 226 08024</b>	Pin rail	420 0	<b>4812 121 08251</b>	Capacitor 5µ f 380V
047 0	<b>4812 532 88051</b>	Bushing gray	440 0	<b>4812 028 58347</b>	Motor fan
047 1	<b>4812 532 88052</b>	Cover gray	441 0	<b>4812 028 58346</b>	Motor fan freezer
047 2	<b>4812 446 88153</b>	Bushing	480 0	<b>4812 019 78857</b>	Cable harness
050 0	<b>4812 440 29498</b>	Plinth gray	490 0	<b>4812 019 78858</b>	Cable mains
050 1	<b>4812 435 18111</b>	Clamp	526 0	<b>4812 236 78535</b>	Control board
050 2	<b>4812 440 29499</b>	Cover gray	564 0	<b>4812 252 28045</b>	Thermal fuse
086 0	<b>4812 404 48923</b>	Support	614 0	<b>4812 218 38622</b>	Relay
086 1	<b>4812 535 38083</b>	Pin	643 0	<b>4812 215 38022</b>	Thermometer SPACE 4
086 2	<b>4812 226 08021</b>	Pin rail	651 0	<b>4812 134 88061</b>	Lamp 220V-15W
101 0	<b>4812 416 10483</b>	Door freezer IN	652 0	<b>4812 255 18277</b>	Holder lamp
101 1	<b>4812 413 78768</b>	Cover right	652 1	<b>4812 462 28624</b>	Protector lamp
101 2	<b>4812 413 78769</b>	Cover left	652 2	<b>4812 404 68043</b>	Support lamp
101 3	<b>4812 236 78542</b>	Control board LCD	691 0	<b>4812 134 28075</b>	Sensor temper.
103 0	<b>4812 262 78016</b>	Cover freezer	702 0	<b>4812 526 48253</b>	Tube
103 1	<b>4812 440 29481</b>	Cover crisper	740 0	<b>4812 511 48336</b>	Condenser
104 0	<b>4812 416 10482</b>	Door refrigerator IN	740 1	<b>4812 462 28394</b>	Holder evaporator
110 0	<b>4812 498 18745</b>	Handle freezer door assembly	740 2	<b>4812 404 49608</b>	Spacer
110 1	<b>4812 498 18746</b>	Handle refrigerator door assy.	743 0	<b>4812 440 79167</b>	Air diffuser set
111 7	<b>4812 459 18218</b>	Nameplate	743 2	<b>4812 462 28641</b>	Cover air diffuser
152 0	<b>4812 418 48729</b>	Door dairy freezer	743 4	<b>4812 442 29294</b>	Air guide
152 1	<b>4812 418 48731</b>	Door dairy	743 5	<b>4812 462 28626</b>	Cover air diffuser
152 2	<b>4812 418 28726</b>	Support can	745 0	<b>4812 511 38326</b>	Evaporator
152 3	<b>4812 418 89016</b>	Holder can	745 2	<b>4812 440 29472</b>	Spacebar right
152 5	<b>4812 418 28728</b>	Separator bottles	745 3	<b>4812 440 29473</b>	Spacebar left
152 6	<b>4812 418 28817</b>	Bottle shelf door	745 4	<b>4812 404 38735</b>	Support sensor
156 0	<b>4812 460 88297</b>	Holder eggs	746 1	<b>4812 462 28627</b>	Cover front evaporator
191 0	<b>4812 468 18329</b>	Gasket fre. door gray	746 2	<b>4812 462 28945</b>	Cover evaporator rear
191 1	<b>4812 468 18331</b>	Gasket ref. door gray	746 3	<b>4812 404 18457</b>	Support sensor
239 0	<b>4812 690 28035</b>	Ice maker	762 0	<b>4812 310 19208</b>	Filter antibacterial kit
239 1	<b>4812 418 28731</b>	Tank	764 0	<b>4812 480 28051</b>	Dryer
239 2	<b>4812 404 38733</b>	Support ice maker	904 0	<b>4812 404 49842</b>	Clamp right
239 3	<b>4812 418 28733</b>	Tray icecube	904 1	<b>4812 404 49843</b>	Clamp left
241 0	<b>4812 418 29953</b>	Shelf freezer	904 2	<b>4812 526 48192</b>	Bushing
241 1	<b>4812 418 48799</b>	Shelf	904 3	<b>4812 226 08023</b>	Pin
241 3	<b>4812 418 28736</b>	Drawer			
242 0	<b>4812 418 29954</b>	Drawer vegetables			
242 1	<b>4812 418 28812</b>	Front crisper			
242 2	<b>4812 418 28738</b>	Spacer			
255 0	<b>4812 450 88481</b>	Glass shelf			
255 1	<b>4812 450 88315</b>	Shelf			

**Exploded view**

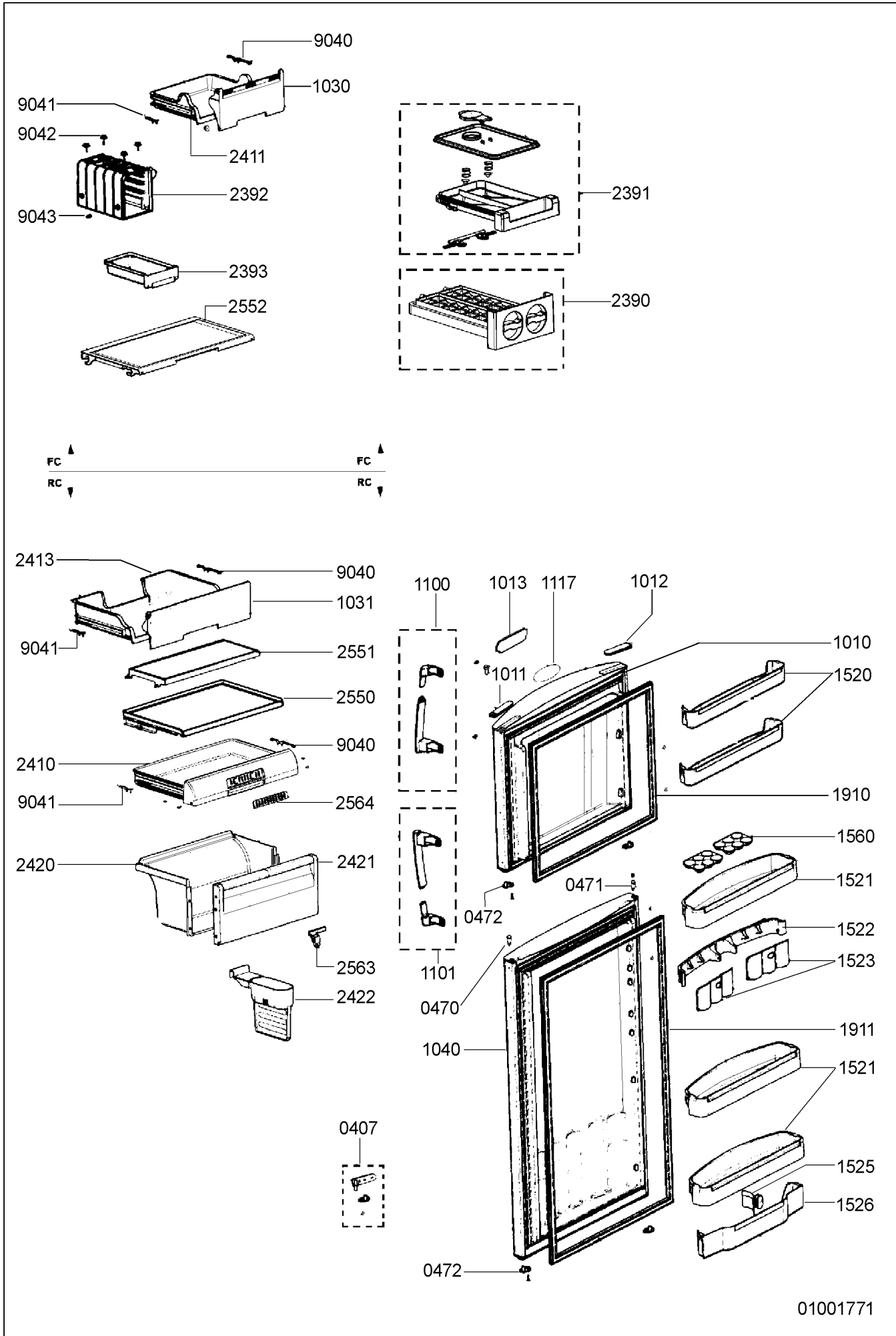

**Exploded view**

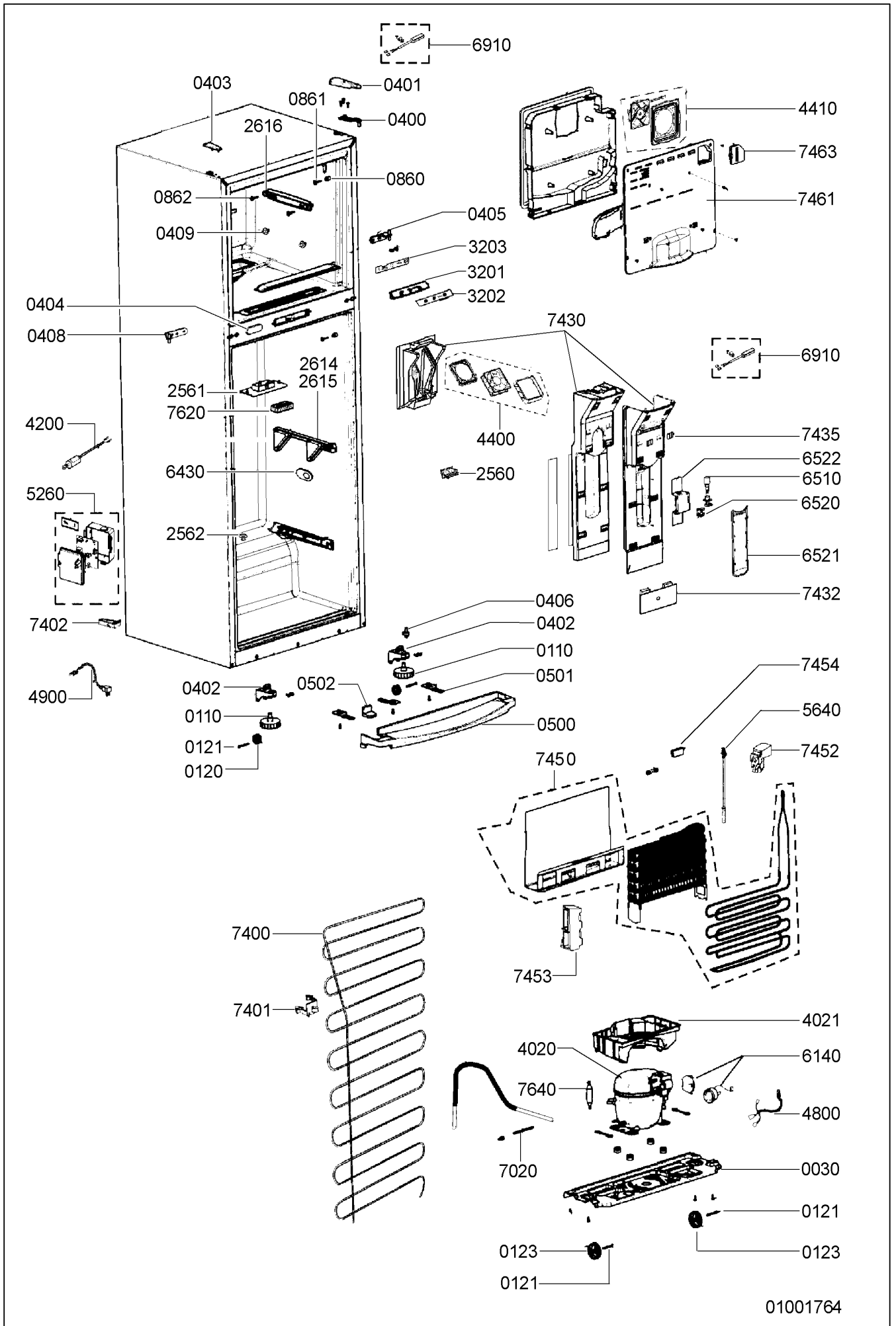

**Circuit and Wiring diagram**

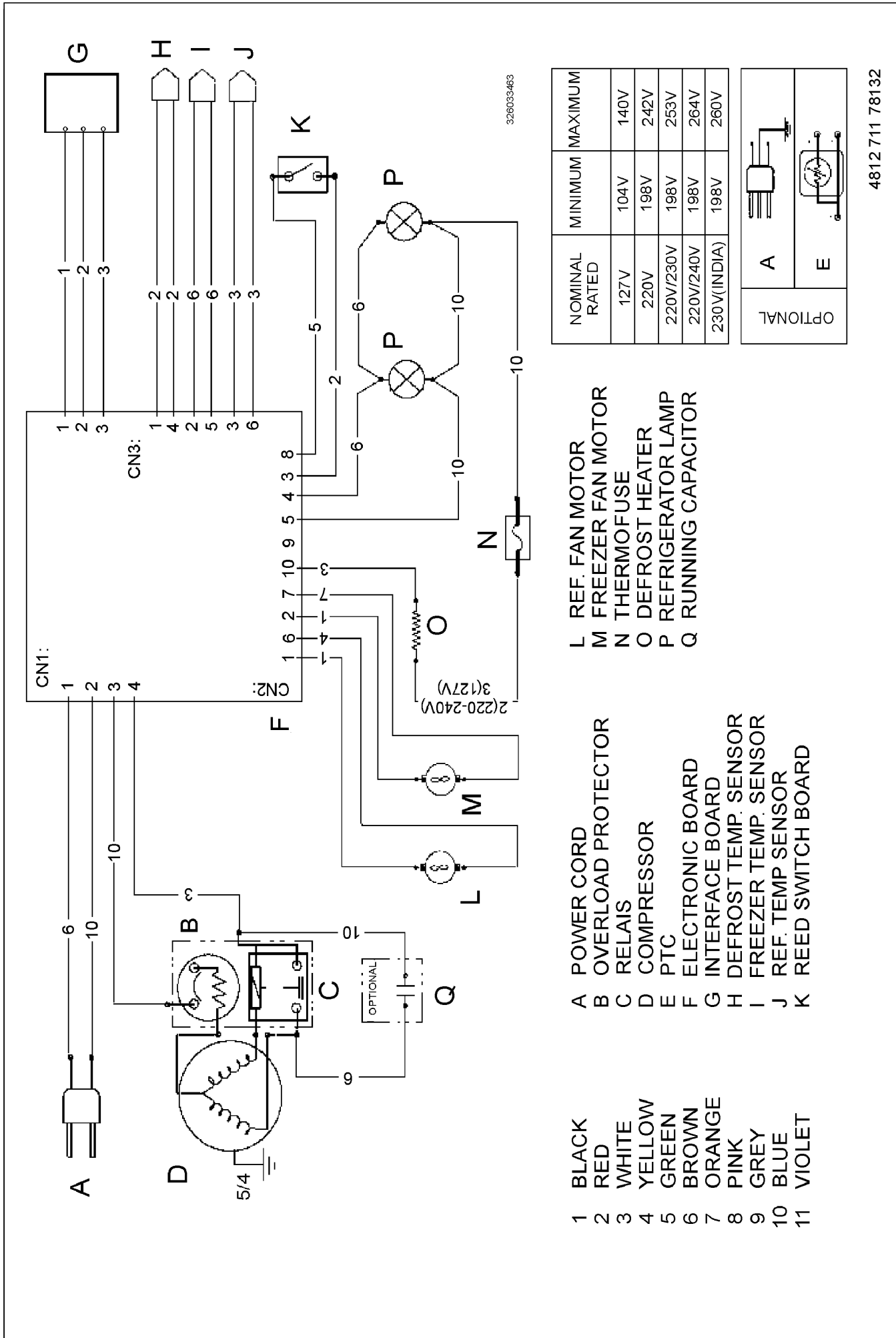

- 1 BLACK
  - 2 RED
  - 3 WHITE
  - 4 YELLOW
  - 5 GREEN
  - 6 BROWN
  - 7 ORANGE
  - 8 PINK
  - 9 GREY
  - 10 BLUE
  - 11 VIOLET
- A POWER CORD
  - B OVERLOAD PROTECTOR
  - C RELAIS
  - D COMPRESSOR
  - E PTC
  - F ELECTRONIC BOARD
  - G INTERFACE BOARD
  - H DEFROST TEMP. SENSOR
  - I FREEZER TEMP. SENSOR
  - J REF. TEMP SENSOR
  - K REED SWITCH BOARD
  - L REF. FAN MOTOR
  - M FREEZER FAN MOTOR
  - N THERMOFUSE
  - O DEFROST HEATER
  - P REFRIGERATOR LAMP
  - Q RUNNING CAPACITOR

NOMINAL RATED	MINIMUM	MAXIMUM
127V	104V	140V
220V	198V	242V
220V/230V	198V	253V
220V/240V	198V	264V
230V(INDIA)	198V	260V

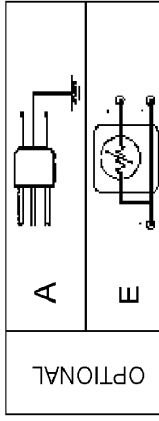

4812 711 78132